

Soils Map

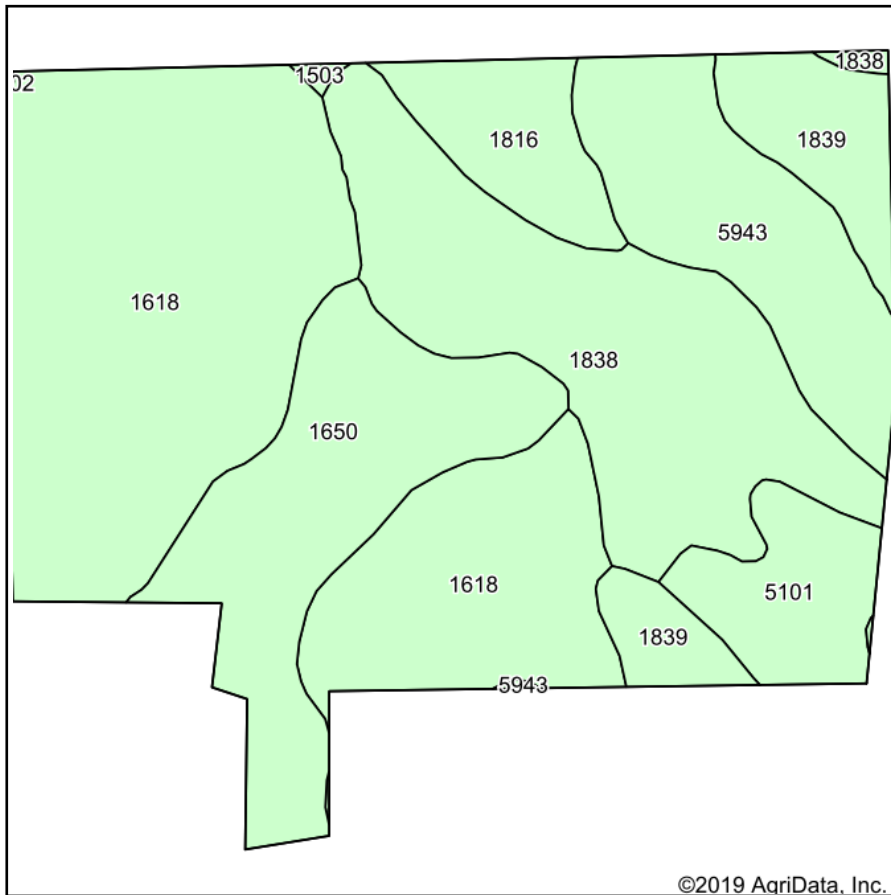

Soils data provided by USDA and NRCS.

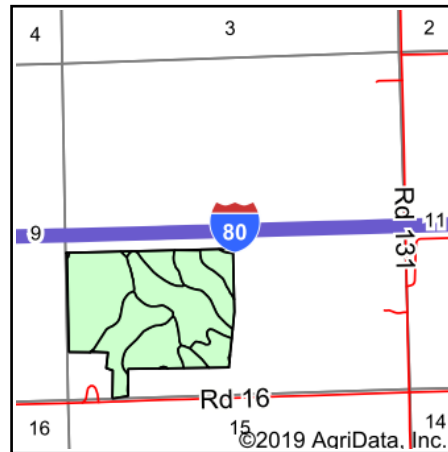

State: **Nebraska**
 County: **Cheyenne**
 Location: **10-13N-48W**
 Township: **Sidney 4B**
 Acres: **107.78**
 Date: **4/10/2020**



915 Main St • Bridgeport, NE 69336 • 308-262-1150

Maps Provided By:



Area Symbol: NE033. Soil Area Version: 19												
Code	Soil Description	Acres	Percent of field	Non-Irr Class *c	Irr Class *c	Range Production (lbs/acre/yr)	SRPG	Corn Irrigated	Dry beans Irrigated	Winter wheat	Winter wheat Irrigated	*n NCCPI Soybeans
1618	Keith loam, 1 to 3 percent slopes	41.25	38.3%	Ile	Ile	1727	63	134				55
1838	Sidney loam, 3 to 6 percent slopes	21.23	19.7%	IIle	IIle	1700	42	125	30	32		34
1650	Kuma loam, 0 to 1 percent slopes	15.87	14.7%	Ilc	Iw	1703	58	144	38	40	79	53
5943	Duroc loam, 1 to 3 percent slopes	11.51	10.7%	Ile	Ile	2495	54	140	38	45		41
1839	Sidney-Canyon complex, 3 to 9 percent slopes	6.90	6.4%	IVe		1475	25			15		24
5101	Alliance loam, 1 to 3 percent slopes	5.62	5.2%	Ile	Ile	1703	61	140	38	41		47
1816	Satanta loam, gravelly substratum, 1 to 3 percent slopes	5.14	4.8%	Ile	Ile	1700	57	140	38	38		46
1503	Altvan loam, 3 to 6 percent slopes	0.19	0.2%	IVe	IVe	1500	45	87		22		33
5102	Alliance loam, 3 to 6 percent slopes	0.07	0.1%	IIle	IIle	1700	57	130	34	36		44
Weighted Average						1781.1	54.3	126.3	19.4	22	11.6	*n 46.2

*n: The aggregation method is "Weighted Average using major components"

*c: Using Capabilities Class Dominant Condition Aggregation Method

Soils data provided by USDA and NRCS.