

# Soils Map

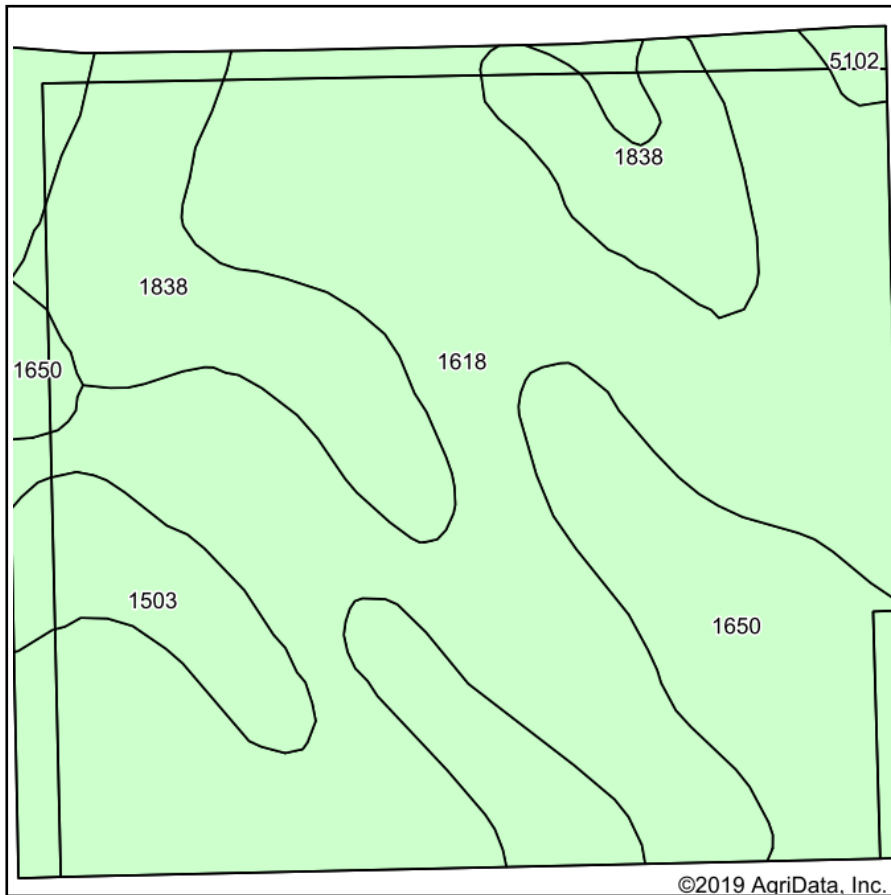

Soils data provided by USDA and NRCS.

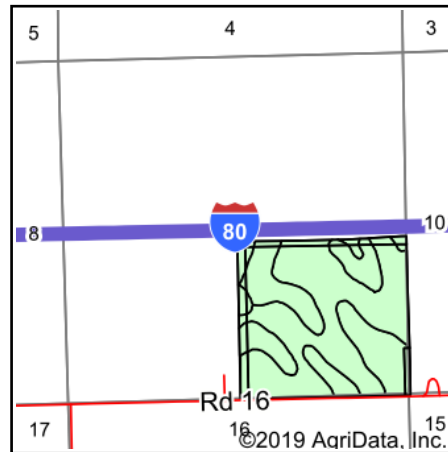

State: **Nebraska**  
 County: **Cheyenne**  
 Location: **9-13N-48W**  
 Township: **Sidney 4B**  
 Acres: **146.11**  
 Date: **4/10/2020**

**KRAUPIE'S**  
 REAL ESTATE & AUCTIONEERS  
**farmauction.net**  
 915 Main St • Bridgeport, NE 69336 • 308-262-1150

Maps Provided By:  
  
 CUSTOMIZED ONLINE MAPPING  
 © AgriData, Inc. 2019 [www.AgriDataInc.com](http://www.AgriDataInc.com)



Area Symbol: NE033. Soil Area Version: 19												
Code	Soil Description	Acres	Percent of field	Non-Irr Class *c	Irr Class *c	Range Production (lbs/acre/yr)	SRPG	Corn Irrigated	Dry beans Irrigated	Winter wheat	Winter wheat Irrigated	*n NCCPI Soybeans
1618	Keith loam, 1 to 3 percent slopes	86.37	59.1%	Ile	Ile	1727	63	134				55
1650	Kuma loam, 0 to 1 percent slopes	26.08	17.8%	Ilc	Iw	1703	58	144	38	40	79	53
1838	Sidney loam, 3 to 6 percent slopes	24.81	17.0%	IIle	IIle	1700	42	125	30	32		34
1503	Altvan loam, 3 to 6 percent slopes	7.92	5.4%	IVe	IVe	1500	45	87		22		33
5102	Alliance loam, 3 to 6 percent slopes	0.93	0.6%	IIle	IIle	1700	57	130	34	36		44
<b>Weighted Average</b>						<b>1705.7</b>	<b>57.5</b>	<b>131.7</b>	<b>12.1</b>	<b>14</b>	<b>14.1</b>	<b>*n 49.8</b>

\*n: The aggregation method is "Weighted Average using major components"

\*c: Using Capabilities Class Dominant Condition Aggregation Method

Soils data provided by USDA and NRCS.