

# Soils Map

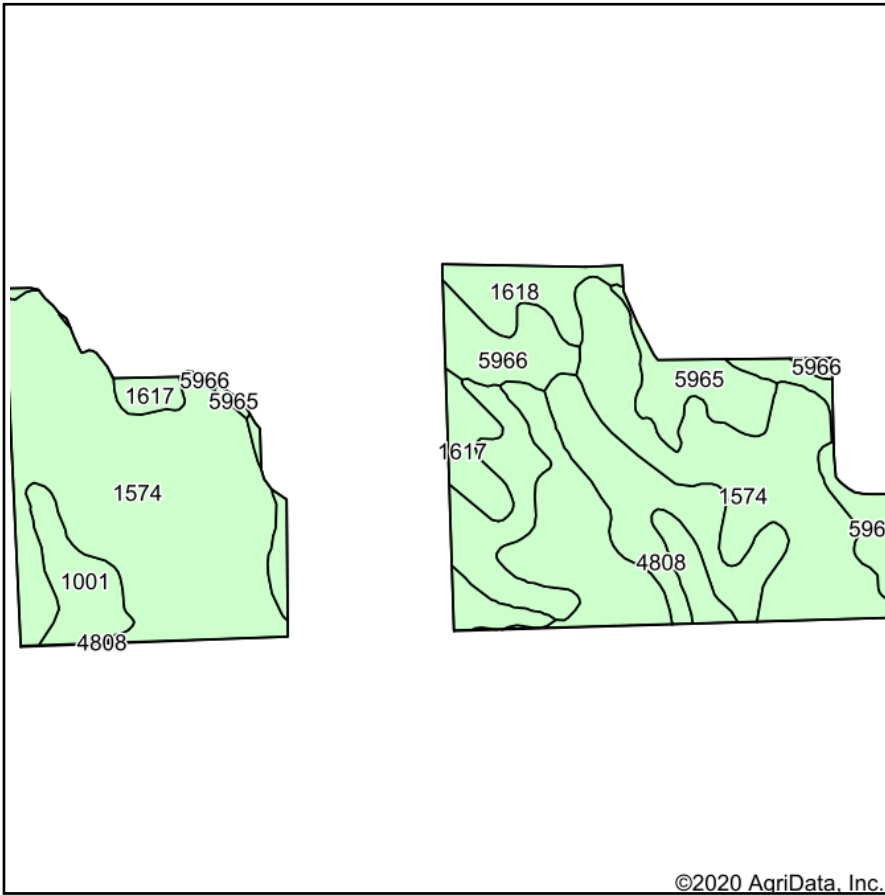

Soils data provided by USDA and NRCS.

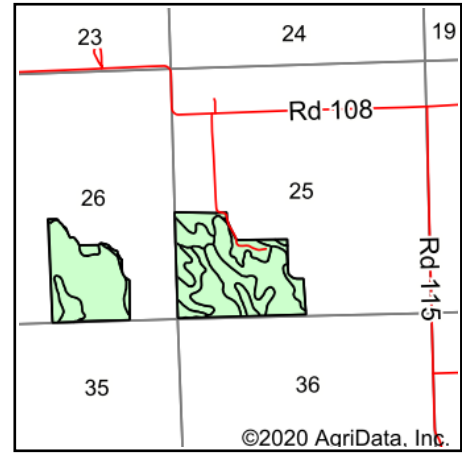

State: **Nebraska**  
 County: **Morrill**  
 Location: **25-21N-49W**  
 Township: **North Camp Clarke**  
 Acres: **171.59**  
 Date: **12/22/2020**



Code	Soil Description	Acres	Percent of field	Non-Irr Class *c	Irr Class *c	Range Production (lbs/acre/yr)	SRPG	Corn Irrigated	Dry beans Irrigated	Sugar beets Irrigated	Winter wheat	*n NCCPI Soybeans
1574	Dix loamy coarse sand, 6 to 50 percent slopes	96.72	56.4%	Vlls		600	1					2
1618	Keith loam, 1 to 3 percent slopes	18.75	10.9%	Ile	Ile	1727	63	134				55
4808	Valentine fine sand, rolling, 9 to 24 percent slopes, dry	15.99	9.3%	Vle		1810						11
5965	Jayem fine sandy loam, 0 to 3 percent slopes	11.28	6.6%	Ille	Ile	1789	45	106	28	18	32	34
1617	Keith loam, 0 to 1 percent slopes	10.92	6.4%	Ilc	lw	1307	64	133	36	23	42	55
1001	Bankard fine sand, channeled, frequently flooded	10.04	5.9%	VIw		2605	17					5
5966	Jayem fine sandy loam, 3 to 6 percent slopes	7.89	4.6%	IVe	Ille	1799	44	102	24	14	27	33
<b>Weighted Average</b>						<b>1131.5</b>	<b>17.5</b>	<b>34.8</b>	<b>5.2</b>	<b>3.3</b>	<b>6</b>	<b>*n 15.7</b>

\*n: The aggregation method is "Weighted Average using all components"

\*c: Using Capabilities Class Dominant Condition Aggregation Method

Soils data provided by USDA and NRCS.