

Soils Map

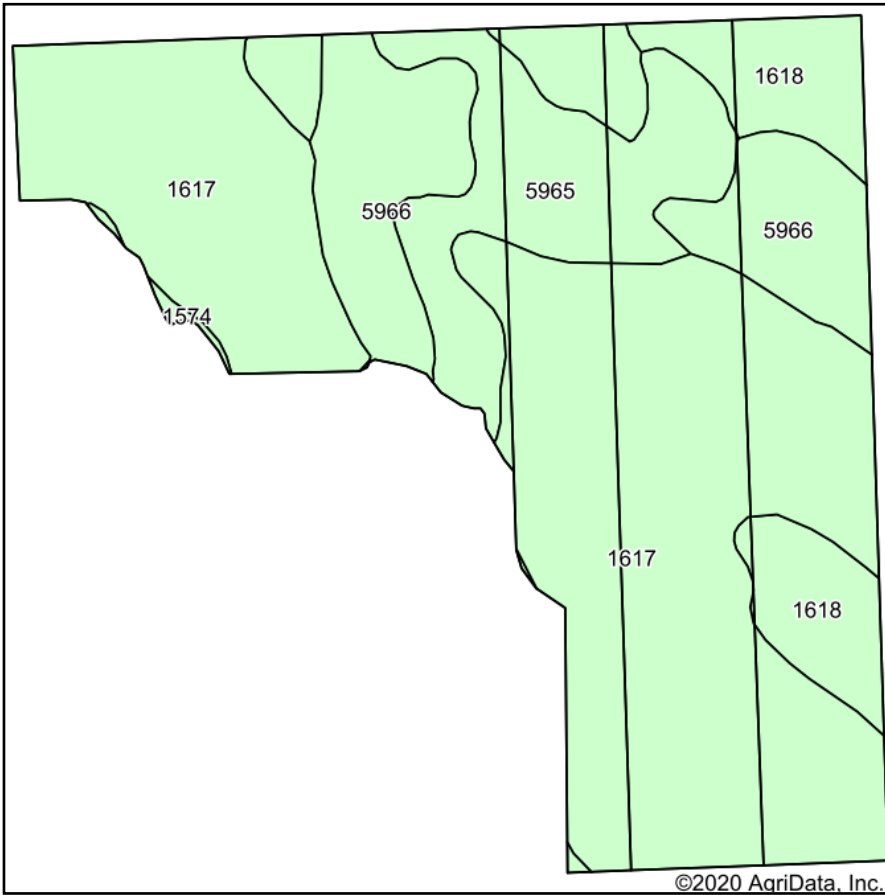

Soils data provided by USDA and NRCS.

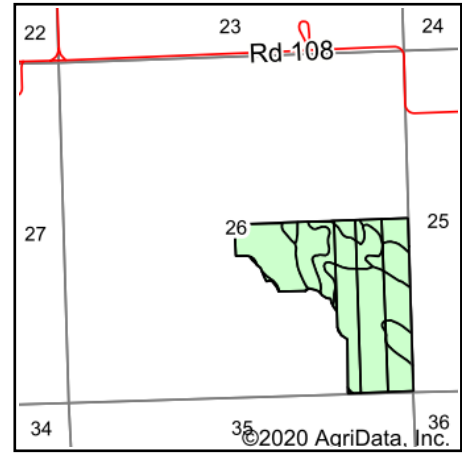

State: **Nebraska**
 County: **Morrill**
 Location: **26-21N-49W**
 Township: **North Camp Clarke**
 Acres: **99.49**
 Date: **12/22/2020**



915 Main St • Bridgeport, NE 69336 • 308-262-1150

Maps Provided By:



© AgriData, Inc. 2020

www.AgriDataInc.com



Code	Soil Description	Acres	Percent of field	Non-Irr Class *c	Irr Class *c	Range Production (lbs/acre/yr)	SRPG	Corn Irrigated	Dry beans Irrigated	Sugar beets Irrigated	Winter wheat	*n NCCPI Soybeans
1617	Keith loam, 0 to 1 percent slopes	61.22	61.5%	IIc	Iw	1307	64	133	36	23	42	55
5965	Jayem fine sandy loam, 0 to 3 percent slopes	14.46	14.5%	IIIe	Ile	1789	45	106	28	18	32	34
5966	Jayem fine sandy loam, 3 to 6 percent slopes	14.12	14.2%	IVe	IIIe	1799	44	102	24	14	27	33
1618	Keith loam, 1 to 3 percent slopes	9.28	9.3%	Ile	Ile	1727	63	134				55
1574	Dix loamy coarse sand, 6 to 50 percent slopes	0.41	0.4%	VIIc		600	1					2
Weighted Average						1483.1	58	124.2	29.6	18.8	34.3	*n 48.6

*n: The aggregation method is "Weighted Average using all components"

*c: Using Capabilities Class Dominant Condition Aggregation Method

Soils data provided by USDA and NRCS.