

Soils Map

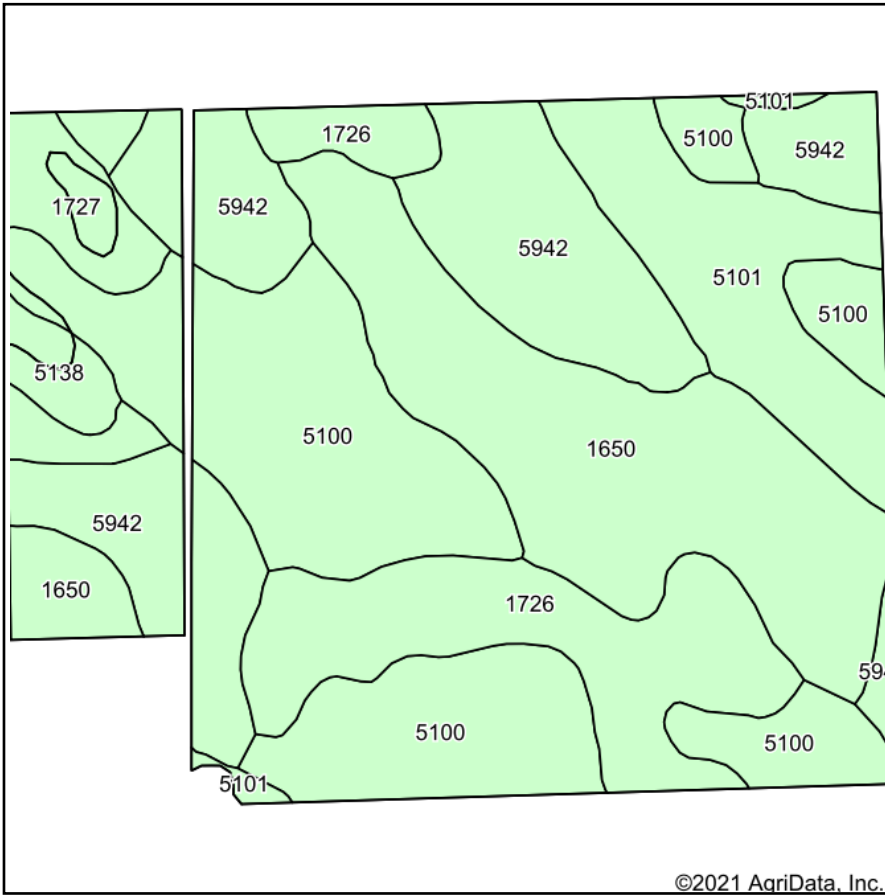

Soils data provided by USDA and NRCS.

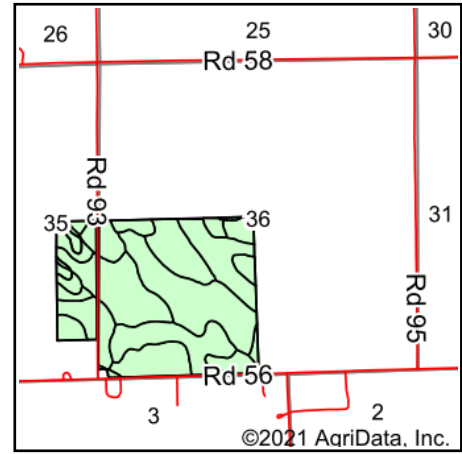

State: **Nebraska**
 County: **Cheyenne**
 Location: **36-17N-51W**
 Township: **Union Valley**
 Acres: **187.43**
 Date: **2/12/2021**



915 Main St • Bridgeport, NE 69336 • 308-262-1150

Maps Provided By:



© AgriData, Inc. 2021

www.AgriDataInc.com



Code	Soil Description	Acres	Percent of field	Non-Irr Class *c	Irr Class *c	Range Production (lbs/acre/yr)	SRPG	Corn Irrigated	Dry beans Irrigated	Winter wheat	Winter wheat Irrigated	*n NCCPI Soybeans
5100	Alliance loam, 0 to 1 percent slopes	51.39	27.4%	IIc	Iw	1703	61	144	40	43		50
1650	Kuma loam, 0 to 1 percent slopes	42.55	22.7%	IIc	Iw	1703	58	144	38	40	79	57
5942	Duroc loam, 0 to 1 percent slopes	39.97	21.3%	IIc	Iw	2450	56					60
1726	Rosebud loam, 1 to 3 percent slopes	26.27	14.0%	IIIe	IIIe	1703	31	124	32	28	62	38
5101	Alliance loam, 1 to 3 percent slopes	18.64	9.9%	IIe	IIe	1703	61	140	38	41		49
1727	Rosebud loam, 3 to 6 percent slopes	5.52	2.9%	IVe	IIIe	1700	30	110	28	31		35
5138	Busher-Tassel complex, 3 to 9 percent slopes	3.09	1.6%	IVe	IVe	1380	4	70	18	19		29
Weighted Average						1856.9	53.2	107.9	29	30.1	26.6	*n 51.2

*n: The aggregation method is "Weighted Average using all components"

*c: Using Capabilities Class Dominant Condition Aggregation Method

Soils data provided by USDA and NRCS.