

Soils Map

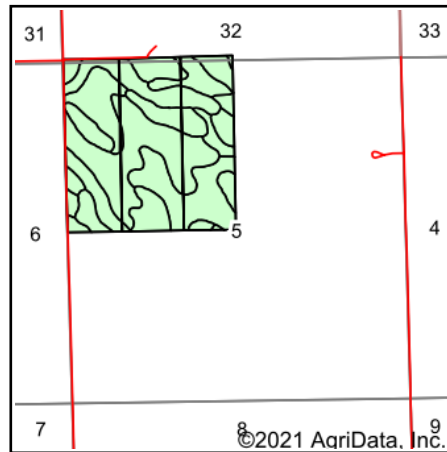

State: **Nebraska**
 County: **Morrill**
 Location: **5-18N-51W**
 Township: **Redington**
 Acres: **162.54**
 Date: **3/10/2021**

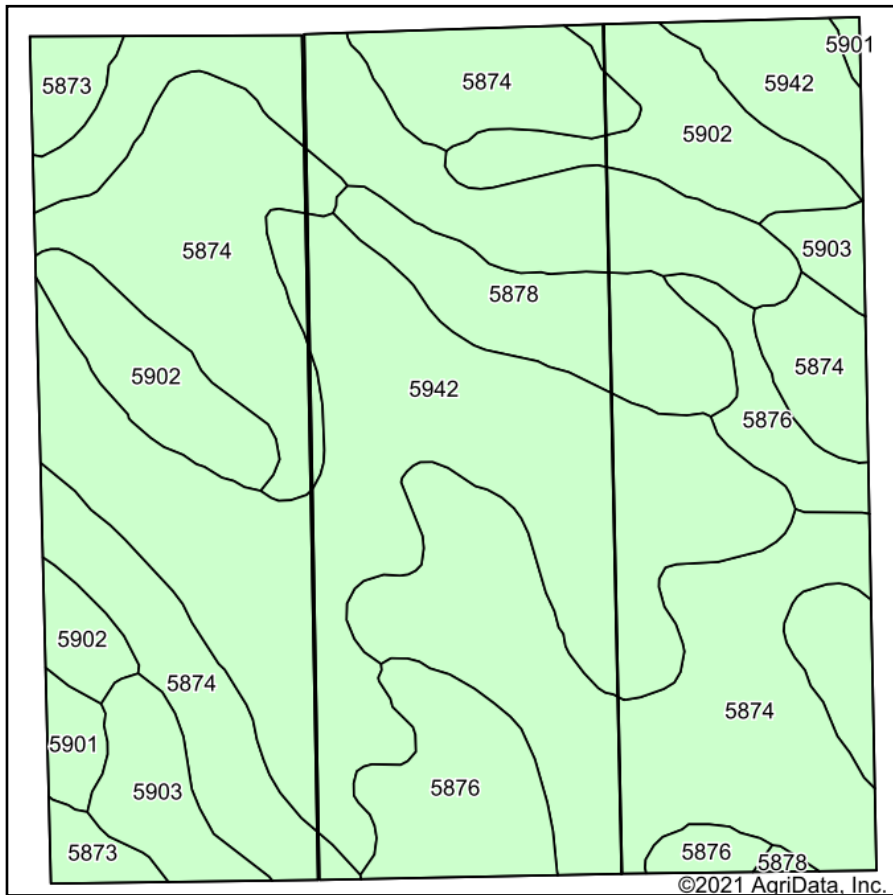

915 Main St • Bridgeport, NE 69336 • 308-262-1150

Maps Provided By:

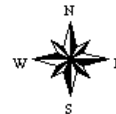

Soils data provided by USDA and NRCS.

Area Symbol: NE123, Soil Area Version: 21

Code	Soil Description	Acres	Percent of field	Non-Irr Class *c	Irr Class *c	Range Production (lbs/acre/yr)	SRPG	Corn Irrigated	Dry beans Irrigated	Sugar beets Irrigated	Winter wheat	*n NCCPI Soybeans
5942	Duroc loam, 0 to 1 percent slopes	59.09	36.4%	IIc	Iw	2450	57					60
5874	Tripp very fine sandy loam, 1 to 3 percent slopes	55.16	33.9%	IIIe	Ile	1693	57	130	37	24	38	44
5902	Alice fine sandy loam, 3 to 6 percent slopes	14.73	9.1%	IVe	IIIe	1881	42	119	31	19	30	37
5876	Tripp very fine sandy loam, 3 to 6 percent slopes	14.27	8.8%	IIIe	IIIe	1700	55	120	32	20	34	44
5878	Tripp very fine sandy loam, 6 to 9 percent slopes	8.68	5.3%	IVe	IVe	1700	52	110	29	18	27	43
5903	Alice fine sandy loam, 6 to 9 percent slopes, eroded	5.67	3.5%	IVe	IVe	1900	40	115	26	17	26	33
5873	Tripp very fine sandy loam, 0 to 1 percent slopes	3.17	2.0%	IIIc	Ile	1693	59	140	41	27	39	44
5901	Alice fine sandy loam, 0 to 3 percent slopes	1.77	1.1%	IIIe	Ile	1881	44	129	36	23	36	38
Weighted Average						1995.5	54.5	79.5	21.8	14	22.1	*n 48.7

*n: The aggregation method is "Weighted Average using all components"

*c: Using Capabilities Class Dominant Condition Aggregation Method

Soils data provided by USDA and NRCS.