

Soils Map

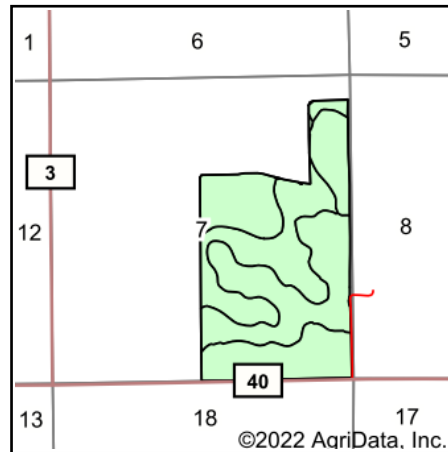

State: **Nebraska**
 County: **Kimball**
 Location: **7-15N-58W**
 Township: **Bushnell**
 Acres: **232.72**
 Date: **9/9/2022**

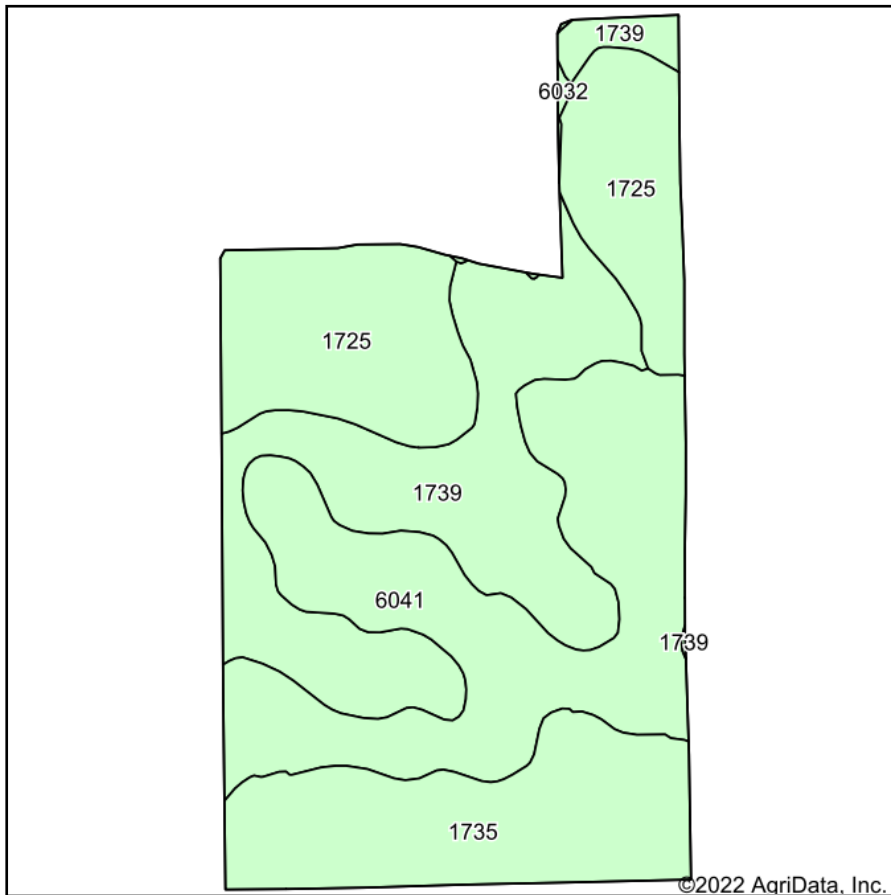

Area Symbol: NE105, Soil Area Version: 21

Code	Soil Description	Acres	Percent of field	Non-Irr Class *c	Irr Class *c	Range Production (lbs/acre/yr)	SRPG	Corn Irrigated Bu	*n NCCPI Soybeans
6041	Tassel-Blanche sandy loams, 3 to 9 percent slopes	72.05	31.0%	Vle		1280	16	29	17
1739	Rosebud-Canyon loams, 1 to 3 percent slopes	65.10	28.0%	IIle	IIIe	1390	5	81	26
1725	Rosebud loam, 0 to 1 percent slopes	52.30	22.5%	IIc	IIs	1477	34	120	28
1735	Rosebud-Blanche complex , 1 to 3 percent slopes	42.76	18.4%	IIIe	IIIe	1325	29	105	28
6032	Tassel-Blanche complex, 9 to 30 percent slopes	0.51	0.2%	VIc		1215	14		13
Weighted Average				3.71	*-	1363.2	19.4	77.9	*n 24

*n: The aggregation method is "Weighted Average using all components"

*c: Using Capabilities Class Dominant Condition Aggregation Method

*- Irr Class weighted average cannot be calculated on the current soils data due to missing data.

Soils data provided by USDA and NRCS.