

Soils Map

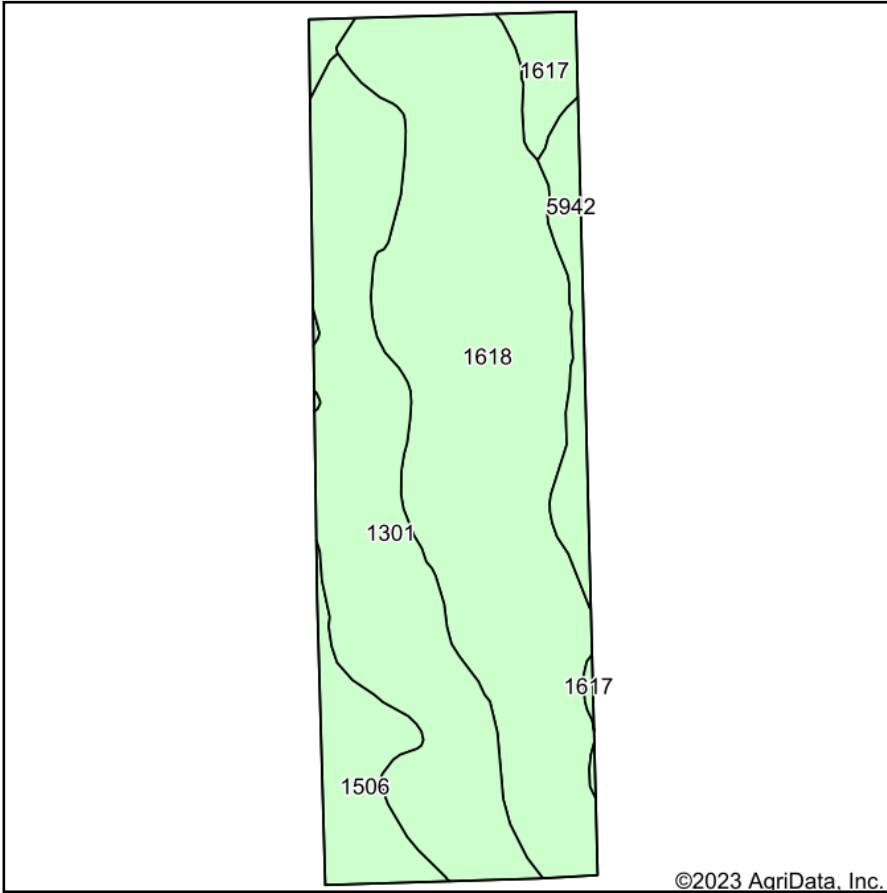

Soils data provided by USDA and NRCS.

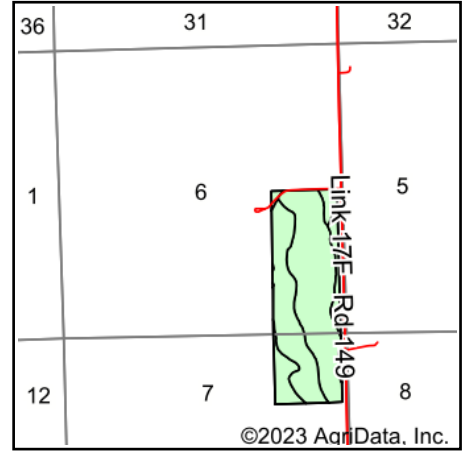

State: **Nebraska**
 County: **Cheyenne**
 Location: **6-13N-46W**
 Township: **Lodgepole**
 Acres: **110.2**
 Date: **1/6/2023**



Area Symbol: NE033, Soil Area Version: 22

Code	Soil Description	Acres	Percent of field	Non-Irr Class *c	Irr Class *c	Range Production (lbs/acre/yr)	SRPG	Corn Irrigated Bu	Dry beans Irrigated Bu	Sugar beets Irrigated Tons	Winter wheat Bu	*n NCCPI Soybeans
1618	Keith loam, 1 to 3 percent slopes	56.68	51.4%	Ile	Ile	1727	63	134				54
1301	Bayard fine sandy loam, 3 to 6 percent slopes	35.16	31.9%	IVe	IIIe	2416	43	124	32		34	38
1506	Altvan-Dix complex, 3 to 9 percent slopes	9.29	8.4%	IVe	IVe	1543	27					31
5942	Duroc loam, 0 to 1 percent slopes	5.40	4.9%	IIc	Iw	2450	56					60
1617	Keith loam, 0 to 1 percent slopes	3.67	3.3%	IIc	Iw	1307	64	133	36	23	42	55
Weighted Average				2.81	2.41	1952.8	53.3	112.9	11.4	0.8	12.2	*n 47.3

*n: The aggregation method is "Weighted Average using all components"

*c: Using Capabilities Class Dominant Condition Aggregation Method

Soils data provided by USDA and NRCS.