

Soils Map

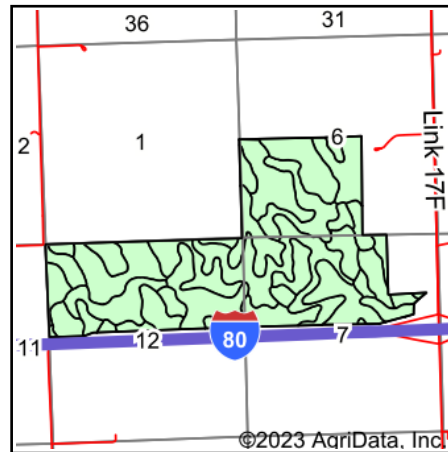

State: **Nebraska**
 County: **Cheyenne**
 Location: **6-13N-46W**
 Township: **Lodgepole**
 Acres: **703.01**
 Date: **1/12/2023**

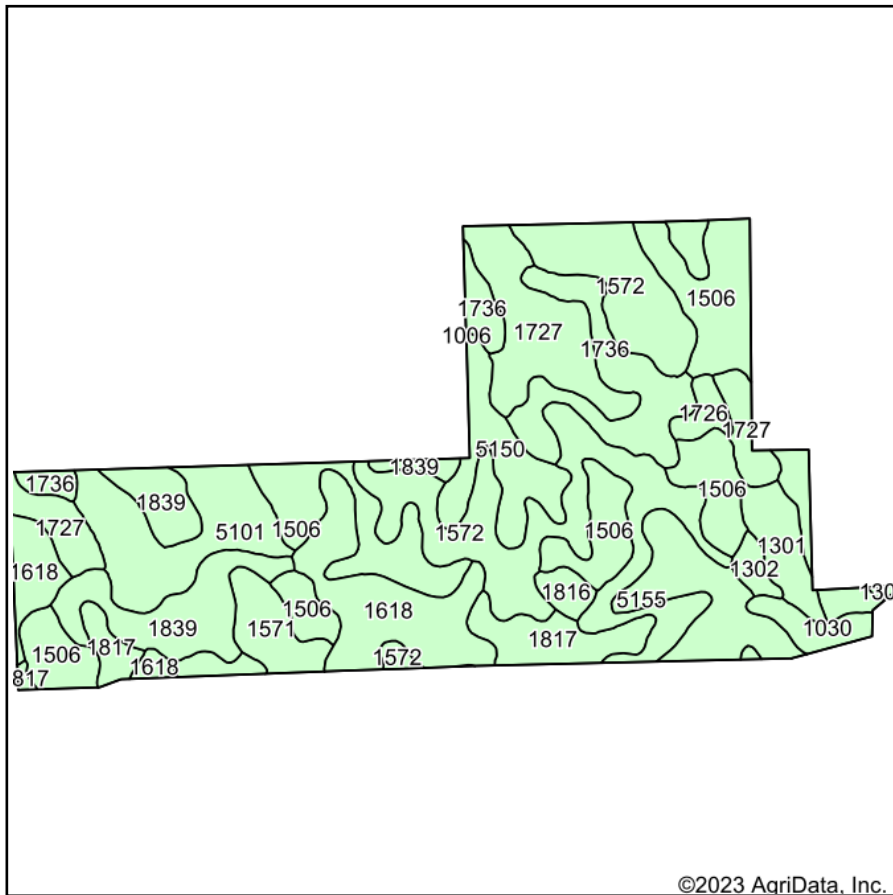

915 Main St • Bridgeport, NE 69336 • 308-262-1150

Maps Provided By:



© AgriData, Inc. 2021

www.AgriDataInc.com



Soils data provided by USDA and NRCS.

©2023 AgriData, Inc.

Area Symbol: NE033, Soil Area Version: 22

Code	Soil Description	Acres	Percent of field	Non-Irr Class *c	Irr Class *c	Range Production (lbs/acre/yr)	SRPG	Corn Irrigated Bu	Dry beans Irrigated Bu	Winter wheat Bu	Winter wheat Irrigated Bu	*n NCCPI Soybeans
1506	Altvan-Dix complex, 3 to 9 percent slopes	131.00	18.6%	IVe	IVe	1543	27					31
1572	Dix gravelly loam, 3 to 9 percent slopes	129.66	18.4%	VIs		1200	23					11
1727	Rosebud loam, 3 to 6 percent slopes	64.17	9.1%	IVe	IIIe	1700	30	110	28	31		35
1618	Keith loam, 1 to 3 percent slopes	64.08	9.1%	Ile	Ile	1727	63	134				54
1736	Rosebud-Canyon complex, 3 to 9 percent slopes	51.88	7.4%	IVe		1475	29			15		24
1839	Sidney-Canyon complex, 3 to 9 percent slopes	51.21	7.3%	IVe		1475	25			15		27
5101	Alliance loam, 1 to 3 percent slopes	48.04	6.8%	Ile	Ile	1703	61	140	38	41		49
5155	Canyon-Bayard complex, 6 to 20 percent slopes	35.14	5.0%	VIs		1280	22					23
1817	Satanta loam, gravelly substratum, 3 to 6 percent slopes	34.61	4.9%	IIIe	IIIe	1700	55	125	30	32		48
5150	Canyon fine sandy loam, 6 to 30 percent slopes	29.61	4.2%	VIs		1100	4					11
1301	Bayard fine sandy loam, 3 to 6 percent slopes	17.66	2.5%	IVe	IIIe	2416	43	124	32	34		38
1571	Dix gravelly loam, 9 to 50 percent slopes	17.62	2.5%	VIs		600	3					1



1030	Glenberg fine sandy loam, 0 to 2 percent slopes	10.13	1.4%	IIIe	Ile	2515	37	134	34	36		33
1726	Rosebud loam, 1 to 3 percent slopes	6.82	1.0%	IIIe	IIIe	1703	31	124	32	28	62	38
1816	Satanta loam, gravelly substratum, 1 to 3 percent slopes	6.21	0.9%	Ile	Ile	1700	57	140	38	38		49
1302	Bayard fine sandy loam, 6 to 9 percent slopes	5.17	0.7%	IVe	IVe	1525	41	114	27	29		38
Weighted Average				4.22	*-	1502.8	32.7	46.3	8.8	11.6	0.6	*n 29.5

*n: The aggregation method is "Weighted Average using all components"

*c: Using Capabilities Class Dominant Condition Aggregation Method

*- Irr Class weighted average cannot be calculated on the current soils data due to missing data.

Soils data provided by USDA and NRCS.