

Soils Map

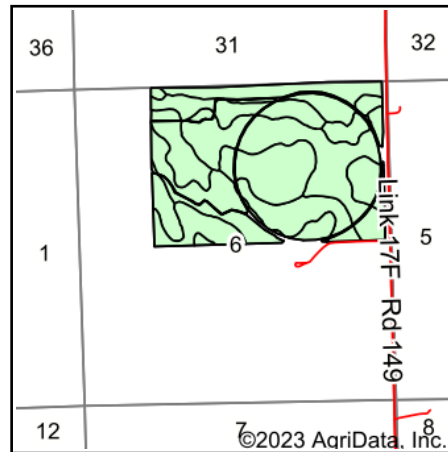

State: **Nebraska**
 County: **Cheyenne**
 Location: **6-13N-46W**
 Township: **Lodgepole**
 Acres: **228.76**
 Date: **1/9/2023**

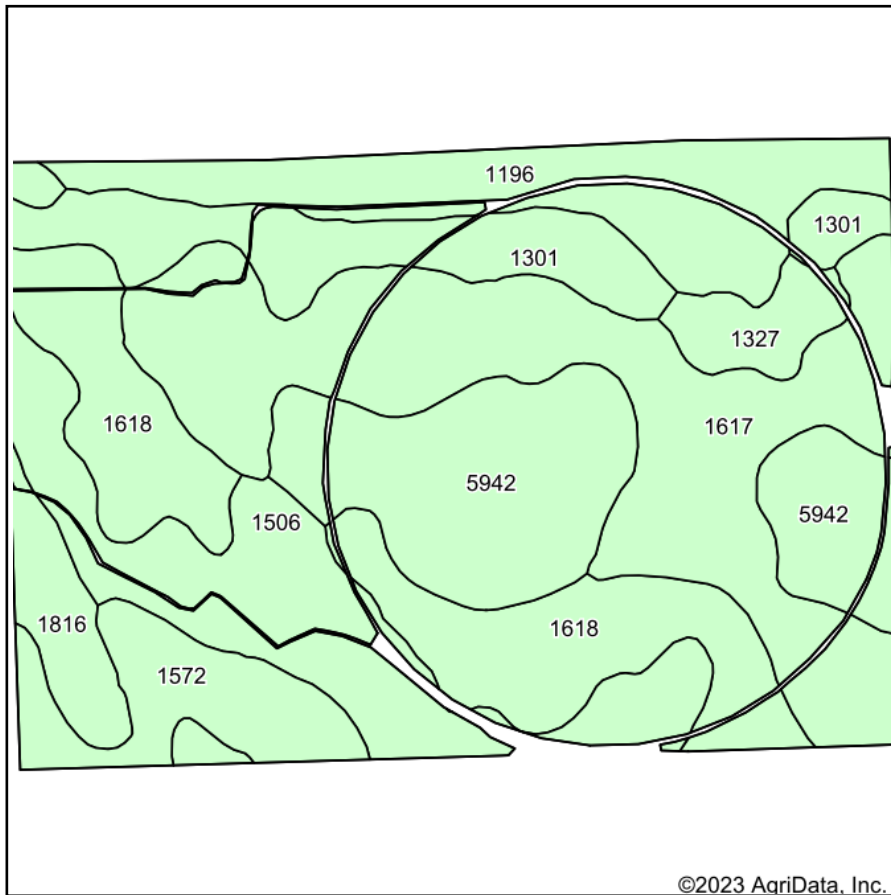

915 Main St • Bridgeport, NE 69336 • 308-262-1150

Maps Provided By:



© AgriData, Inc. 2021

www.AgriDataInc.com



Soils data provided by USDA and NRCS.

Area Symbol: NE033, Soil Area Version: 22

Code	Soil Description	Acres	Percent of field	Non-Irr Class *c	Irr Class *c	Range Production (lbs/acre/yr)	SRPG	Corn Irrigated Bu	Dry beans Irrigated Bu	Sugar beets Irrigated Tons	Winter wheat Bu	*n NCCPI Soybeans
1617	Keith loam, 0 to 1 percent slopes	55.75	24.4%	IIc	Iw	1307	64	133	36	23	42	55
5942	Duroc loam, 0 to 1 percent slopes	35.64	15.6%	IIc	Iw	2450	56					60
1618	Keith loam, 1 to 3 percent slopes	34.08	14.9%	IIe	IIe	1727	63	134				54
1506	Altvan-Dix complex, 3 to 9 percent slopes	30.03	13.1%	IVe	IVe	1543	27					31
1196	Las loam, occasionally flooded	25.08	11.0%	IVw	IIw	4000	43	134	35		28	36
1301	Bayard fine sandy loam, 3 to 6 percent slopes	20.82	9.1%	IVe	IIIe	2416	43	124	32		34	38
1572	Dix gravelly loam, 3 to 9 percent slopes	13.43	5.9%	VIe		1200	23					11
1816	Satanta loam, gravelly substratum, 1 to 3 percent slopes	8.15	3.6%	IIe	IIe	1700	57	140	38		38	49
1327	Bayard fine sandy loam, 0 to 3 percent slopes	5.78	2.5%	IIIe	IIe	1610	52	127	36		37	36
Weighted Average				2.92	*-	1990.2	50.6	86.5	17.8	5.6	18.7	*n 45.6

*n: The aggregation method is "Weighted Average using all components"

*c: Using Capabilities Class Dominant Condition Aggregation Method

*- Irr Class weighted average cannot be calculated on the current soils data due to missing data.

Soils data provided by USDA and NRCS.