

Soils Map

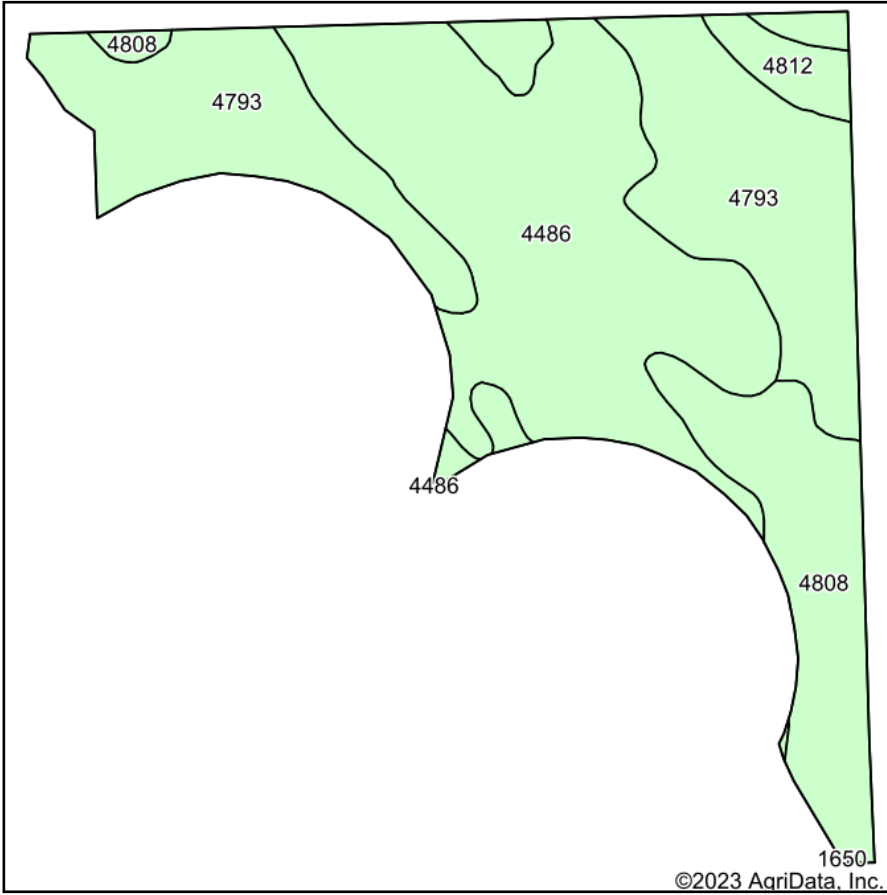

Soils data provided by USDA and NRCS.

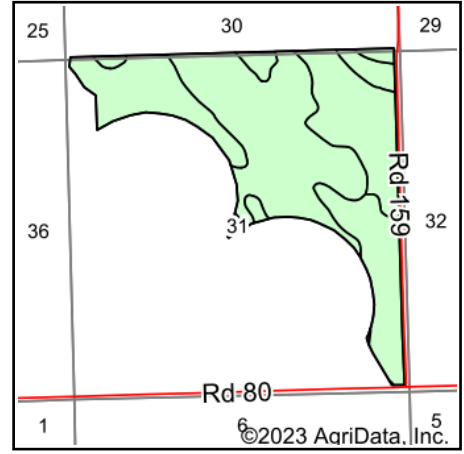

State: **Nebraska**
 County: **Garden**
 Location: **30-19N-45W**
 Township: **Lisco**
 Acres: **246.01**
 Date: **11/14/2023**



915 Main St • Bridgeport, NE 69336 • 308-262-1150

Maps Provided By:



© AgriData, Inc. 2023

www.AgriDataInc.com



Area Symbol: NE069, Soil Area Version: 22

Code	Soil Description	Acres	Percent of field	Non-Irr Class *c	Irr Class *c	Range Production (lbs/acre/yr)	SRPG	Corn Irrigated Bu	Corn Bu	Dry beans Irrigated Bu	Winter wheat Bu	Winter wheat Irrigated Bu	*n NCCPI Soybeans
4486	Dunday loamy fine sand, 0 to 3 percent slopes, dry	100.51	40.9%	IVe		2040		11	2				18
4793	Valentine fine sand, 3 to 9 percent slopes, dry	97.81	39.8%	VIe	IVe	2452		81					14
4808	Valentine fine sand, rolling, 9 to 24 percent slopes, dry	40.61	16.5%	VIe		1810							11
4812	Valentine loamy fine sand, 0 to 3 percent slopes, dry	7.08	2.9%	IVe	IVe	1935		88	1				16
Weighted Average				5.13	*-	2162.8	*-	39.2	0.8	*-	*-	*-	*n 15.2

*n: The aggregation method is "Weighted Average using all components"

*c: Using Capabilities Class Dominant Condition Aggregation Method

*- Irr Class weighted average cannot be calculated on the current soils data due to missing data.

Soils data provided by USDA and NRCS.