

Soils Map

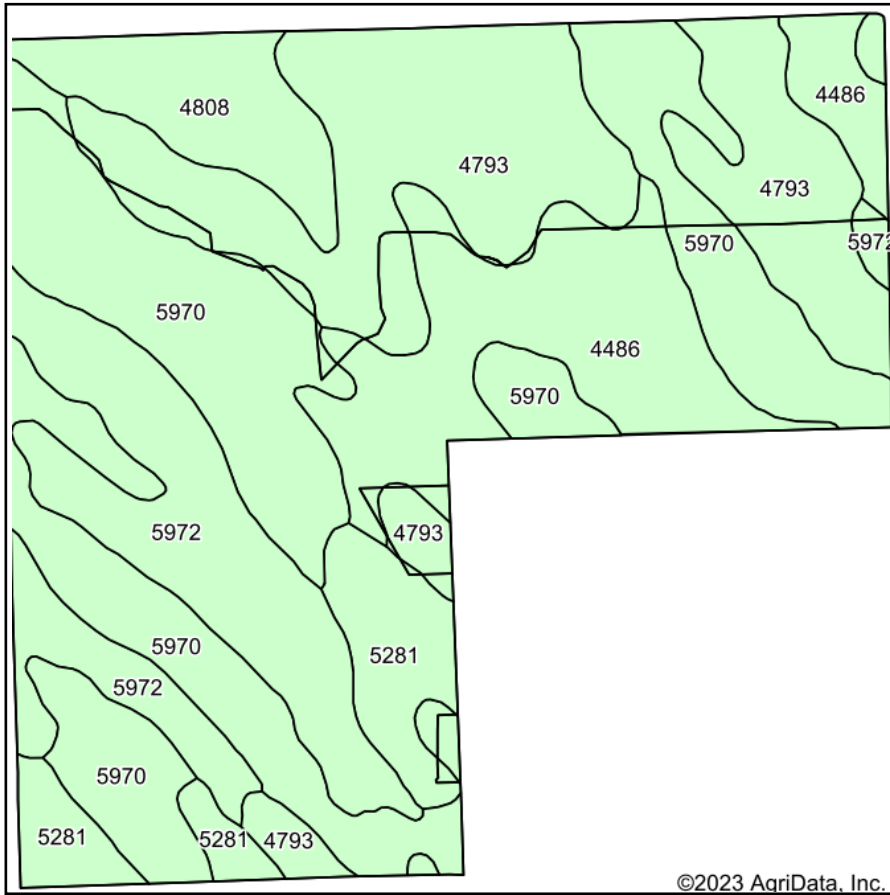

Soils data provided by USDA and NRCS.

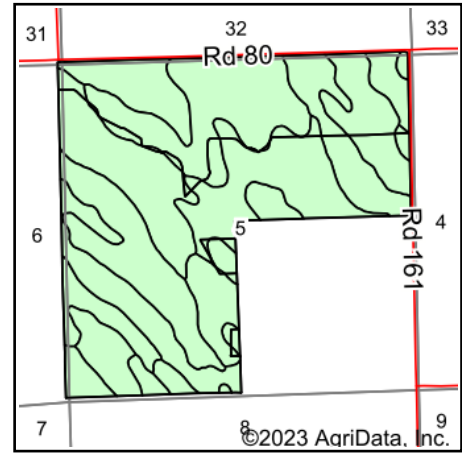

State: **Nebraska**
 County: **Garden**
 Location: **5-18N-45W**
 Township: **Lisco**
 Acres: **459.29**
 Date: **11/14/2023**



915 Main St • Bridgeport, NE 69336 • 308-262-1150

Maps Provided By:



© AgriData, Inc. 2023

www.AgriDataInc.com



Area Symbol: NE069, Soil Area Version: 22

Code	Soil Description	Acres	Percent of field	Non-Irr Class *c	Irr Class *c	Range Production (lbs/acre/yr)	SRPG	Corn Irrigated Bu	Corn Bu	Dry beans Irrigated Bu	Sugar beets Irrigated Tons	Winter wheat Bu	*n NCCPI Soybeans
5970	Jayem loamy fine sand, 0 to 3 percent slopes	147.82	32.2%	IVe	IIIe	2286	42	122		32	20	34	28
4793	Valentine fine sand, 3 to 9 percent slopes, dry	116.12	25.3%	VIe	IVe	2452		81					14
5972	Jayem loamy fine sand, 3 to 6 percent slopes	69.65	15.2%	IVe	IVe	2274	41	104		27	17	31	27
4486	Dunday loamy fine sand, 0 to 3 percent slopes, dry	67.99	14.8%	IVe		2040		11	2				18
5281	Vetal fine sandy loam, 0 to 3 percent slopes	30.90	6.7%	IIIe		1563	52						38
4808	Valentine fine sand, rolling, 9 to 24 percent slopes, dry	26.81	5.8%	VIe		1810							11
Weighted Average				4.56	*-	2213.3	23.2	77.1	0.3	14.4	9	15.6	*n 22.5

*n: The aggregation method is "Weighted Average using all components"

*c: Using Capabilities Class Dominant Condition Aggregation Method

*- Irr Class weighted average cannot be calculated on the current soils data due to missing data.

Soils data provided by USDA and NRCS.