

# Soils Map

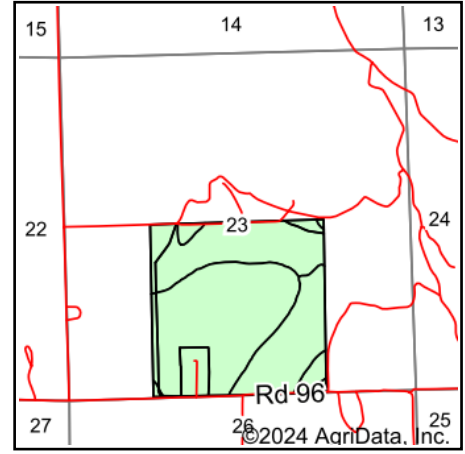

State: **Nebraska**  
 County: **Morrill**  
 Location: **23-20N-50W**  
 Township: **North Camp Clarke**  
 Acres: **163.06**  
 Date: **5/6/2024**

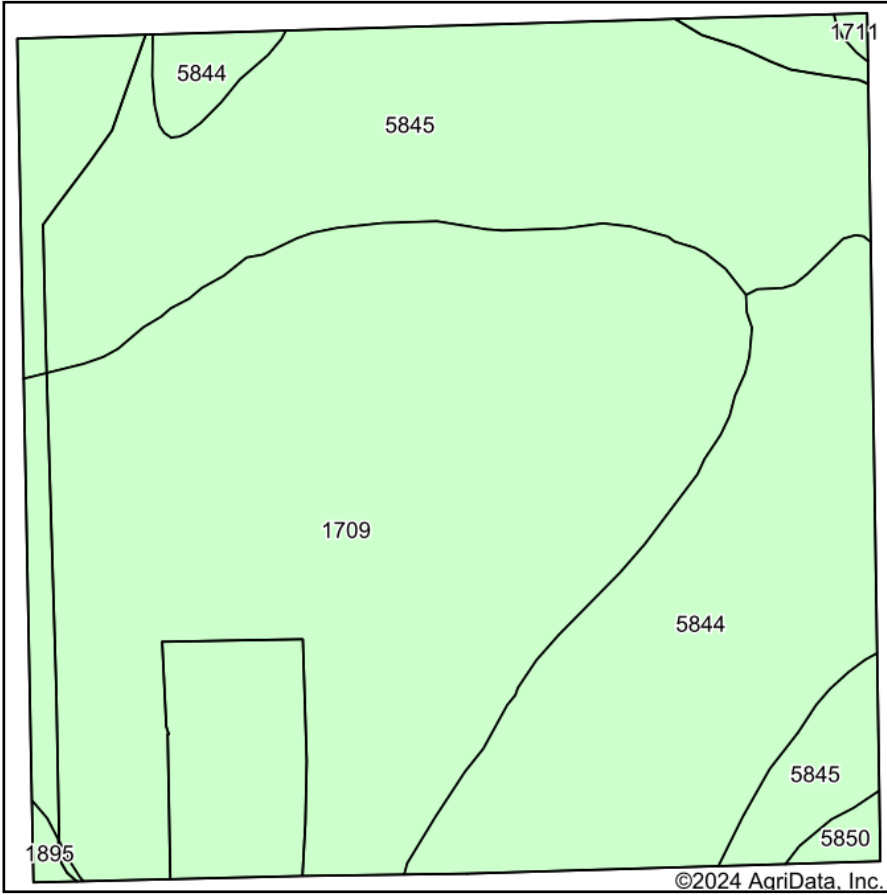

Area Symbol: NE123, Soil Area Version: 24

Code	Soil Description	Acres	Percent of field	Non-Irr Class *c	Irr Class *c	Range Production (lbs/acre/yr)	SRPG	Corn Irrigated Bu	Dry beans Irrigated Bu	Sugar beets Irrigated Tons	Winter wheat Bu	*n NCCPI Soybeans
1709	Otero very fine sandy loam, 0 to 3 percent slopes	80.14	49.1%	IIIe	Ile	1540	43	129	36	23	36	36
5845	Mitchell very fine sandy loam, 3 to 6 percent slopes	47.53	29.1%	IIIe	IIIe	1287	46	129	32	20	32	43
5844	Mitchell very fine sandy loam, 1 to 3 percent slopes	33.82	20.7%	IIIe	Ile	1287	48	134	37	24	36	44
5850	Mitchell-Epping very fine sandy loams, 3 to 9 percent slopes	0.86	0.5%	IVe	IVe	1083	32	105	27	16	25	34
1895	Valent loamy sand, 0 to 3 percent slopes	0.48	0.3%	VIe	IVe	1814						15
1711	Otero very fine sandy loam, 6 to 9 percent slopes	0.23	0.1%	IVe	IVe	1500	40	110	28	17	27	35
<b>Weighted Average</b>				<b>3.02</b>	<b>2.31</b>	<b>1412.1</b>	<b>44.7</b>	<b>129.5</b>	<b>34.9</b>	<b>22.2</b>	<b>34.7</b>	<b>*n 39.6</b>

\*n: The aggregation method is "Weighted Average using all components"

\*c: Using Capabilities Class Dominant Condition Aggregation Method