

Soils Map

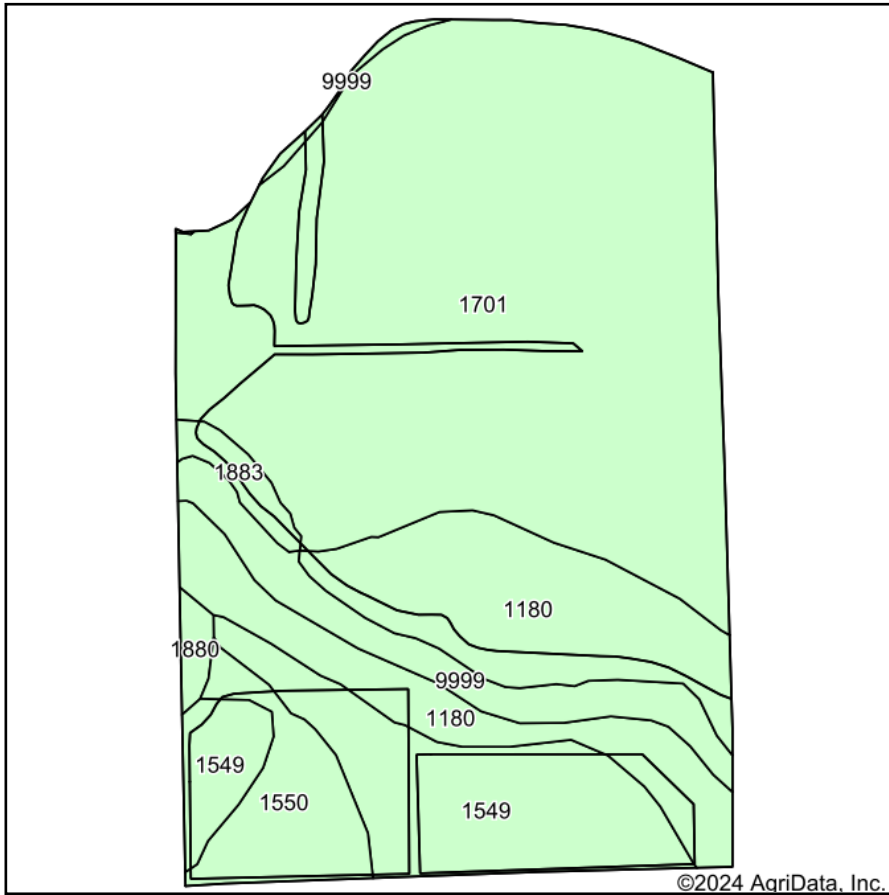

Soils data provided by USDA and NRCS.

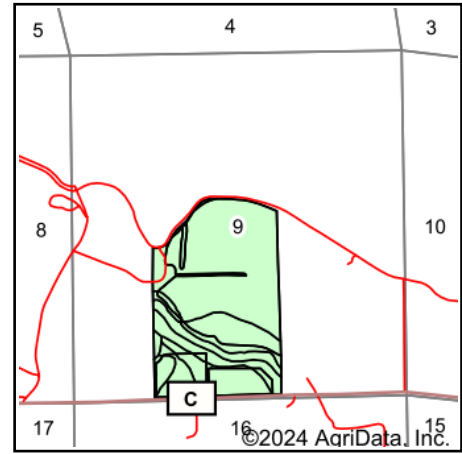

State: **Nebraska**
 County: **Scotts Bluff**
 Location: **9-23N-54W**
 Township: **Funston**
 Acres: **127.5**
 Date: **7/9/2024**



915 Main St • Bridgeport, NE 69336 • 308-262-1150

Maps Provided By:



© AgriData, Inc. 2023

www.AgriDataInc.com



Area Symbol: NE157, Soil Area Version: 22

Code	Soil Description	Acres	Percent of field	Non-Irr Class *c	Irr Class *c	Range Production (lbs/acre/yr)	SRPG	Corn Irrigated Bu	Dry beans Irrigated Bu	Sugar beets Irrigated Tons	Winter wheat Bu	*n NCCPI Soybeans
1701	Otero fine sandy loam, 1 to 6 percent slopes	71.29	55.9%	IVe	IIIe	1485	40	124	28	19	27	29
1180	Las Animas fine sandy loam, occasionally flooded	23.28	18.3%	IIIw	IIIw	2475	37	114	32	20	33	25
1549	Dailey and Valent loamy fine sands, 0 to 3 percent slopes	16.80	13.2%	IVe	IVe	1584	18	114	24	16	20	15
9999	Water	7.37	5.8%			0	0					
1550	Dailey and Valent loamy fine sands, 3 to 6 percent slopes	6.28	4.9%	Vle	IVe	1656	18	109	21	13		15
1883	Valent-Dwyer loamy fine sands, rolling	1.58	1.2%	Vle	IVe	1354	17					10
1880	Valent-Dwyer fine sands, rolling	0.90	0.7%	Vle	IVe	1327	17					9
Weighted Average				*-	*-	1598.7	32.7	110.5	25.7	17	23.8	*n 23.7

*n: The aggregation method is "Weighted Average using all components"

*c: Using Capabilities Class Dominant Condition Aggregation Method

*- Non Irr Class weighted average cannot be calculated on the current soils data due to missing data.

*- Irr Class weighted average cannot be calculated on the current soils data due to missing data.

Soils data provided by USDA and NRCS.