

Soils Map

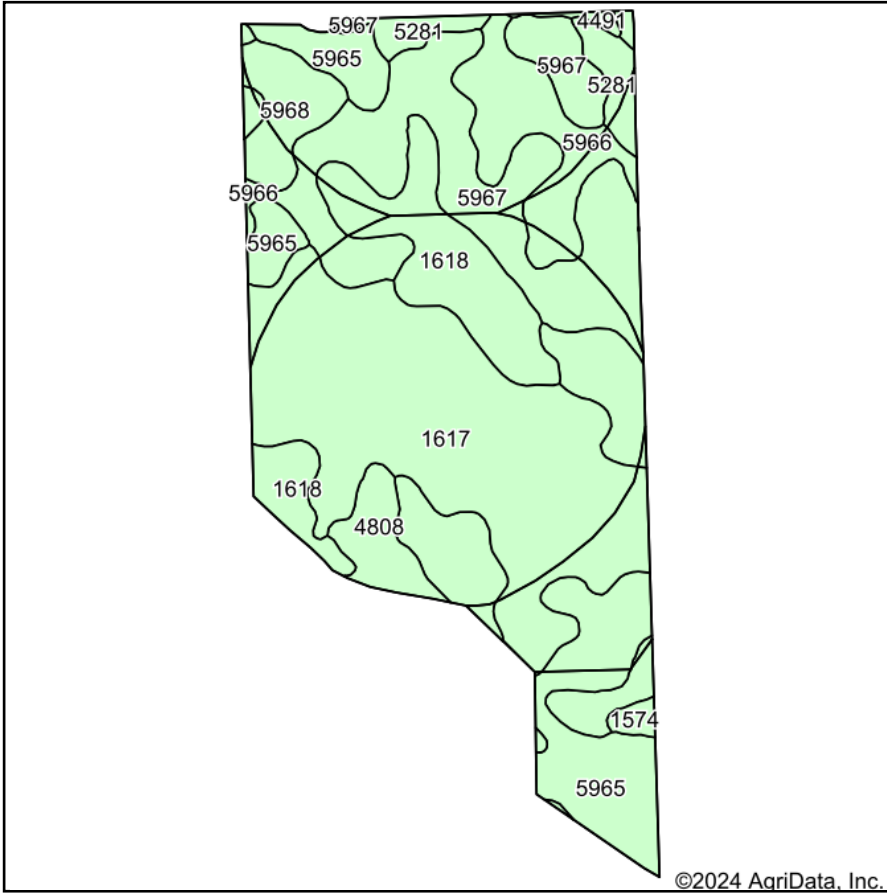

Soils data provided by USDA and NRCS.

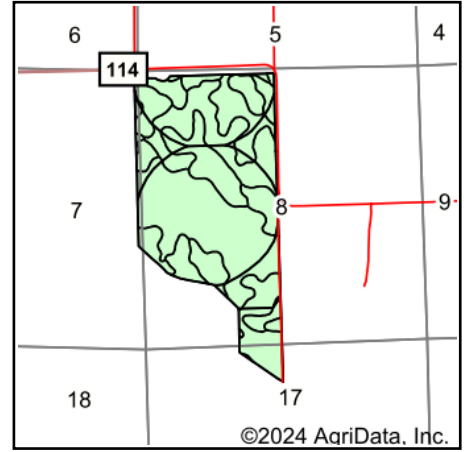

State: **Nebraska**
 County: **Morrill**
 Location: **8-21N-49W**
 Township: **North Camp Clarke**
 Acres: **262.04**
 Date: **10/1/2024**



Area Symbol: NE123, Soil Area Version: 24

Code	Soil Description	Acres	Percent of field	Non-Irr Class *c	Irr Class *c	Range Production (lbs/acre/yr)	SRPG	Corn Irrigated Bu	Corn Bu	Dry beans Irrigated Bu	Sugar beets Irrigated Tons	Winter wheat Bu	*n NCCPI Soybeans
1617	Keith loam, 0 to 1 percent slopes	80.99	30.9%	IIc	Iw	1307	64	133		36	23	42	53
5967	Jayem fine sandy loam, 6 to 9 percent slopes	52.78	20.1%	IVe	IVe	1600	41	110		28	17	28	32
5965	Jayem fine sandy loam, 0 to 3 percent slopes	50.73	19.4%	IIIe	Ile	1789	45	106		28	18	32	33
1618	Keith loam, 1 to 3 percent slopes	27.79	10.6%	Ile	Ile	1727	63	134					53
5966	Jayem fine sandy loam, 3 to 6 percent slopes	18.28	7.0%	IVe	IIIe	1799	44	102		24	14	27	32
5968	Jayem fine sandy loam, 9 to 20 percent slopes	9.49	3.6%	VIe		1600	35						28
4808	Valentine fine sand, rolling, 9 to 24 percent slopes, dry	8.29	3.2%	VIe		1810							11

Soils data provided by USDA and NRCS.



Code	Soil Description	Acres	Percent of field	Non-Irr Class *c	Irr Class *c	Range Production (lbs/acre/yr)	SRPG	Corn Irrigated Bu	Corn Bu	Dry beans Irrigated Bu	Sugar beets Irrigated Tons	Winter wheat Bu	*n NCCPI Soybeans
5281	Vetal fine sandy loam, 0 to 3 percent slopes	7.21	2.8%	IIIe		1563	51						38
5972	Jayem loamy fine sand, 3 to 6 percent slopes	4.25	1.6%	IVe	IVe	2274	36	104		27	17	31	27
1574	Dix loamy coarse sand, 6 to 50 percent slopes	1.41	0.5%	VIIIs		600	1						2
4491	Dunday loamy fine sand, 3 to 9 percent slopes, dry	0.82	0.3%	VIe		1930		11	2				18
Weighted Average				3.11	*-	1585.6	49.8	106.8	*-	24.3	15.3	27.2	*n 40

*n: The aggregation method is "Weighted Average using all components"

*c: Using Capabilities Class Dominant Condition Aggregation Method

*- Irr Class weighted average cannot be calculated on the current soils data due to missing data.