

Soils Map

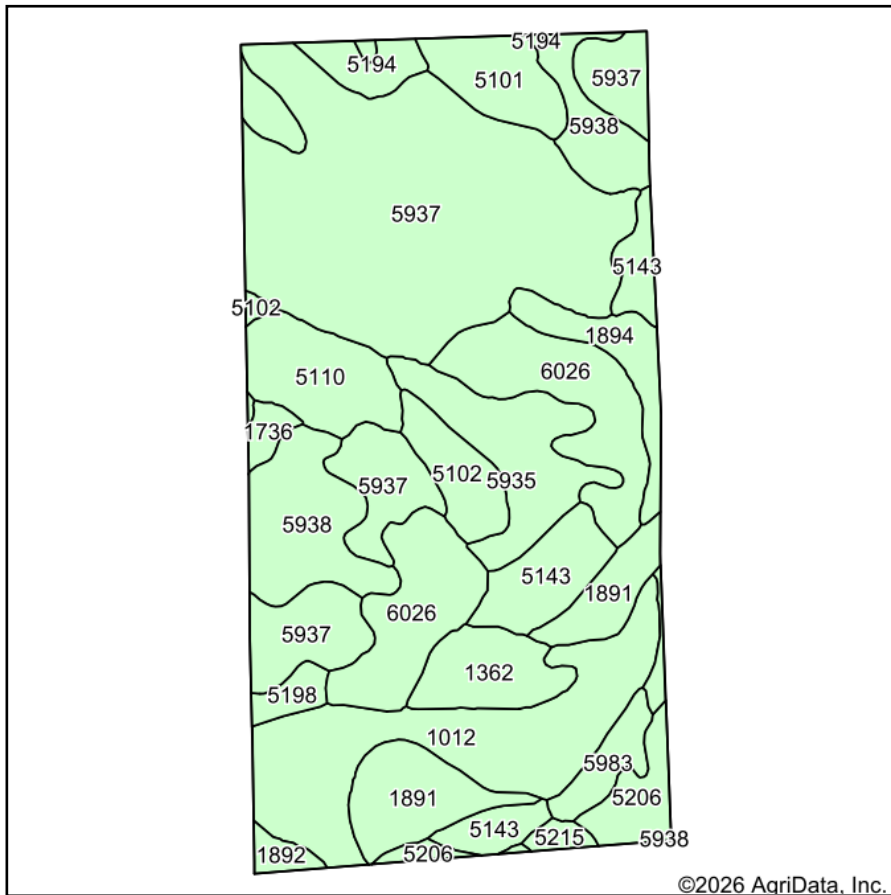

©2026 AgriData, Inc.

Soils data provided by USDA and NRCS.

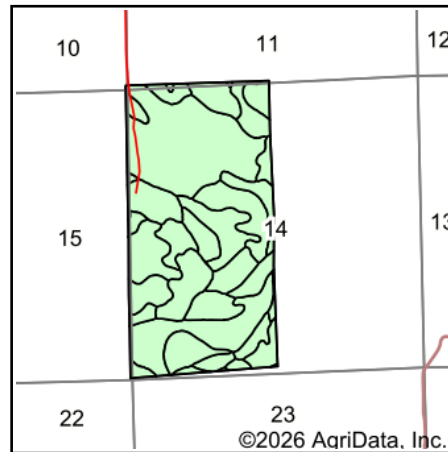

©2026 AgriData, Inc.

State: **Nebraska**
 County: **Box Butte**
 Location: **14-28N-49W**
 Township: **Dorsey**
 Acres: **320.01**
 Date: **2/18/2026**



915 Main St • Bridgeport, NE 69336 • 308-262-1150

Maps Provided By:



© AgriData, Inc. 2025

www.AgriDataInc.com



Area Symbol: NE013, Soil Area Version: 26

Code	Soil Description	Acres	Percent of field	Non-Irr Class *c	Irr Class *c	Range Production (lbs/acre/yr)	SRPG	Corn Irrigated Bu	Corn Bu	Dry beans Irrigated Bu	Sugar beets Irrigated Tons	Winter wheat Bu	*n NCCPI Soybeans
5937	Creighton-Norrest complex, 11 to 30 percent slopes	99.58	31.2%	Vle		1503	24						23
1012	Bankard very fine sandy loam, 0 to 3 percent slopes	35.40	11.1%	IVw	IVw	1800	24	100		27	16	25	19
6026	Tassel loamy very fine sand, 3 to 30 percent slopes	33.71	10.5%	Vls		700	3						14
5938	Creighton-Norrest complex, 6 to 11 percent slopes	23.80	7.4%	IVe	IVe	1540	35					25	29
1891	Valent loamy fine sand, 0 to 3 percent slopes	17.29	5.4%	Vle		1935	25	2	1				16
5143	Busher-Tassel loamy very fine sands, 6 to 30 percent slopes	16.60	5.2%	Vle		1242	21						20
5935	Creighton very fine sandy loam, 3 to 6 percent slopes	16.59	5.2%	IIle	IIle	1765	49						33

Soils data provided by USDA and NRCS.



Code	Soil Description	Acres	Percent of field	Non-Irr Class *c	Irr Class *c	Range Production (lbs/acre/yr)	SRPG	Corn Irrigated Bu	Corn Bu	Dry beans Irrigated Bu	Sugar beets Irrigated Tons	Winter wheat Bu	*n NCCPI Soybeans
5110	Alliance-Rosebud loams, 6 to 11 percent slopes	12.79	4.0%	IVe	IVe	2092	40					27	38
1362	Bridget very fine sandy loam, 1 to 3 percent slopes	9.68	3.0%	Ile	Ile	1859	53	127	33			38	31
5101	Alliance loam, 1 to 3 percent slopes	9.35	2.9%	Ile	Ile	2411	58	140		30	19	34	42
1894	Valent loamy fine sand, 9 to 20 percent slopes	9.03	2.8%	Vle		1935	21	2	1				14
5102	Alliance loam, 3 to 6 percent slopes	8.20	2.6%	IIle	IIle	2395	56	128		26	16	30	41
5194	Norrest loam, 6 to 11 percent slopes	7.54	2.4%	IVe	IVe	1300	20					23	18
5206	Oglala-Canyon complex, 3 to 9 percent slopes	7.32	2.3%	IVe	IVe	1959	38	92		23	14	23	27
5983	Rock outcrop-Tassel complex, 6 to 70 percent slopes	4.95	1.5%	VIIIs	VIII	598	0						4
5198	Norrest-Canyon complex, 9 to 30 percent slopes	2.70	0.8%	Vle		1060	8						12
1736	Rosebud-Canyon complex, 3 to 9 percent slopes	2.02	0.6%	IVe	IVe	1783	20	104		25	16	28	27
1892	Valent loamy fine sand, 3 to 9 percent slopes	1.92	0.6%	Vle		1935	24	2	1				16
5215	Oglala-Canyon very fine sandy loams, 9 to 30 percent slopes	1.54	0.5%	Vle		1831	18						26
Weighted Average				5.01	*-	1567.1	26.7	25.2	1.1	5.2	3.2	9.9	*n 23.2

*n: The aggregation method is "Weighted Average using all components"

*c: Using Capabilities Class Dominant Condition Aggregation Method

*- Irr Class weighted average cannot be calculated on the current soils data due to missing data.