

# Soils Map

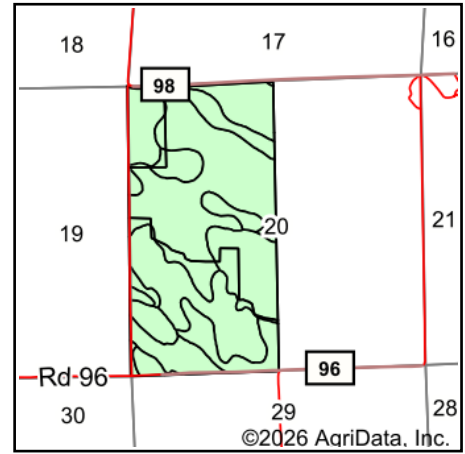

State: **Nebraska**  
 County: **Morrill**  
 Location: **20-20N-47W**  
 Township: **Broadwater**  
 Acres: **327.81**  
 Date: **2/24/2026**

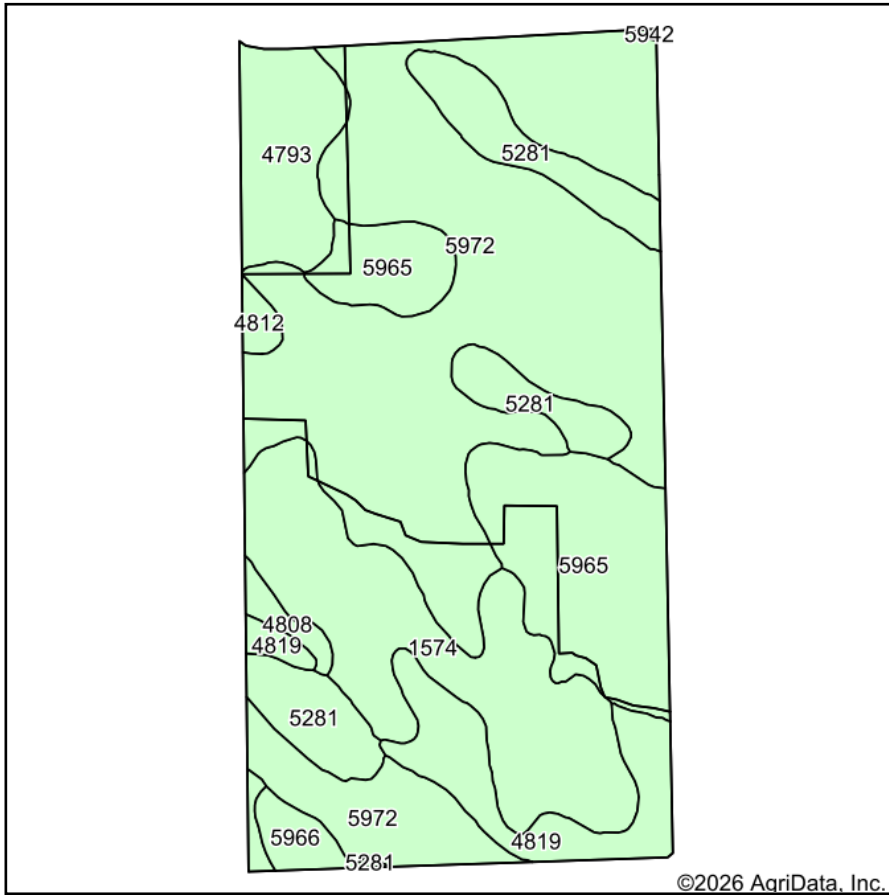

Soils data provided by USDA and NRCS.

Area Symbol: NE123, Soil Area Version: 26

Code	Soil Description	Acres	Percent of field	Non-Irr Class *c	Irr Class *c	Range Production (lbs/acre/yr)	SRPG	Corn Irrigated Bu	Corn Bu	Dry beans Irrigated Bu	Sugar beets Irrigated Tons	Winter wheat Bu	*n NCCPI Soybeans
5972	Jayem loamy fine sand, 3 to 6 percent slopes	149.31	45.7%	IVe	IVe	2274	36	104		27	17	31	27
1574	Dix loamy coarse sand, 6 to 50 percent slopes	53.07	16.2%	VIIIs		600	1						2
5965	Jayem fine sandy loam, 0 to 3 percent slopes	45.69	13.9%	IIle	Ile	1789	45						33
5281	Vetal fine sandy loam, 0 to 3 percent slopes	28.76	8.8%	IIle		1563	51						38
4819	Valentine loamy fine sand, 3 to 9 percent slopes, dry	21.47	6.5%	VIe	IVe	2412		81					16
4793	Valentine fine sand, 3 to 9 percent slopes, dry	18.78	5.7%	VIe	IVe	2452		81					14
5966	Jayem fine sandy loam, 3 to 6 percent slopes	4.40	1.3%	IVe	IIle	1799	44	102		24	14	27	32

Soils data provided by USDA and NRCS.



Code	Soil Description	Acres	Percent of field	Non-Irr Class *c	Irr Class *c	Range Production (lbs/acre/yr)	SRPG	Corn Irrigated Bu	Corn Bu	Dry beans Irrigated Bu	Sugar beets Irrigated Tons	Winter wheat Bu	*n NCCPI Soybeans
4808	Valentine fine sand, rolling, 9 to 24 percent slopes, dry	2.86	0.9%	Vle		1810							11
4812	Valentine loamy fine sand, 0 to 3 percent slopes, dry	2.07	0.6%	IVe	IVe	1935		88	1				16
5967	Jayem fine sandy loam, 6 to 9 percent slopes	1.27	0.4%	IVe	IVe	1600	41	110		28	17	28	32
5942	Duroc loam, 0 to 1 percent slopes	0.13	0.0%	IIc	Iw	2450	57						60
<b>Weighted Average</b>				<b>4.52</b>	<b>*-</b>	<b>1877.1</b>	<b>28.1</b>	<b>59.7</b>	<b>*-</b>	<b>12.7</b>	<b>8</b>	<b>14.6</b>	<b>*n 23.2</b>

\*n: The aggregation method is "Weighted Average using all components"

\*c: Using Capabilities Class Dominant Condition Aggregation Method

\*- Irr Class weighted average cannot be calculated on the current soils data due to missing data.